

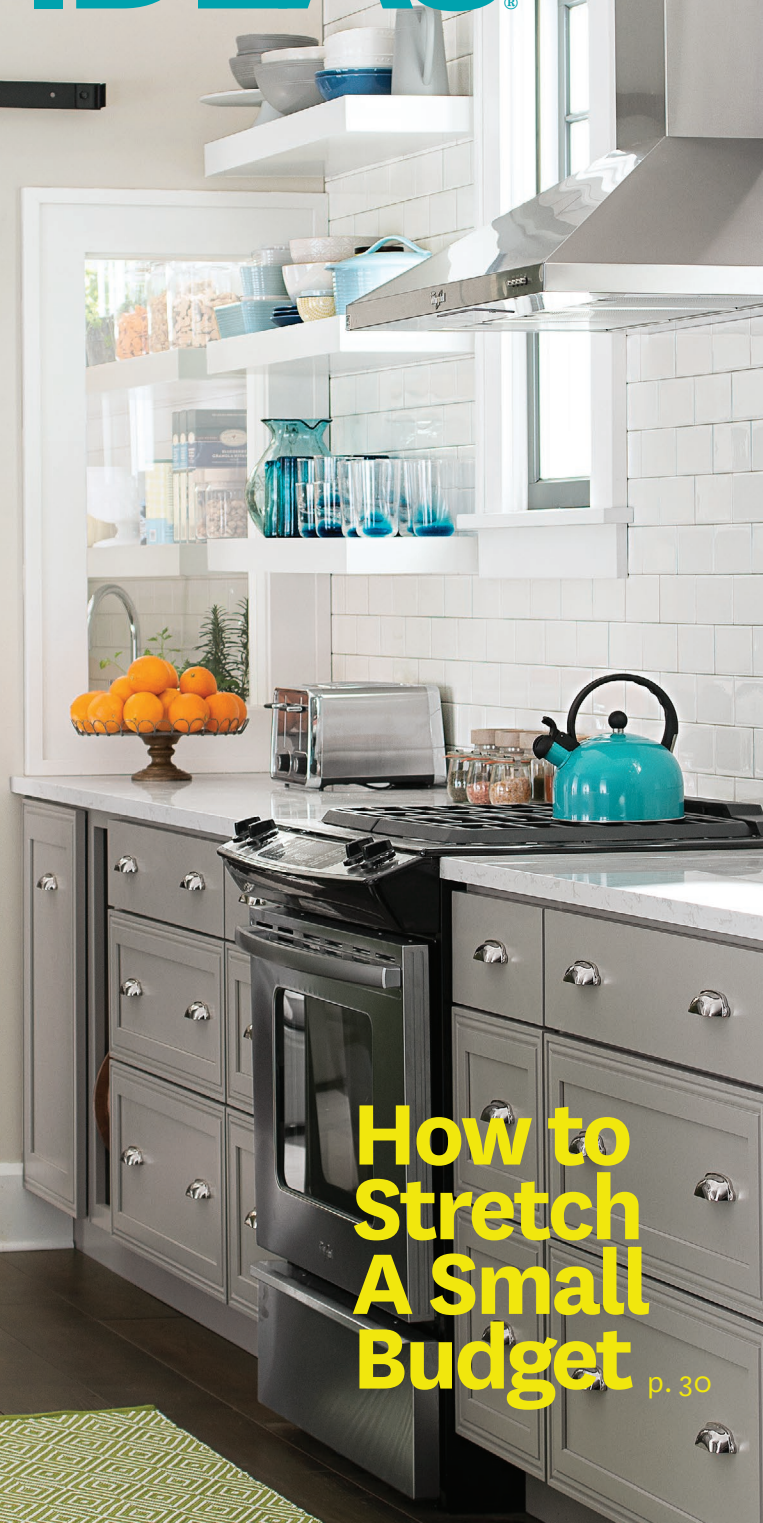

KITCHEN + BATH IDEAS

Get More!
28 Ways to Maximize Your Space



SUMMER 2014
Display until September 8

\$6.99 U.S.

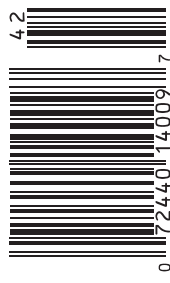

Pick the Perfect Refrigerator p. 26

BEST BATH STORAGE SOLUTIONS p. 32

How to Stretch A Small Budget p. 30

BHG SIP Brown Checkout

BHG.com/KitchenBath

THIS PHOTO: Nestled in a sunlit nook, this sculptural tub is ideal for soothing soaks. A sparkling chandelier and blue-gray tiles complete the setting. **OPPOSITE:** A gleaming tub filler adds old-fashioned elegance.





room to grow

A FEW EXTRA FEET
MAKE ALL THE
DIFFERENCE IN
THIS REDESIGNED
MASTER BATH.

writer and field editor LISA MOWRY
photographer EMILY J. FOLLOWILL



OPPOSITE: Rich walnut-stained cabinetry, polished sconces, and decorative mirrors give the vanity areas traditional character. Molly Downs' vanity includes a separate spot for applying makeup. **BELOW LEFT:** Dripping with crystals, the antique-look chandelier above the tub complements the bath's cove lighting and sconces. **BELOW MIDDLE:** John Downs' side of the bath includes a place for linen storage in the left-hand cabinetry and a mirrored medicine cabinet. **BELOW RIGHT:** Shiny surfaces on the vanity reflect light. The designers chose a polished marble countertop as a contrast to the honed marble floors.



CALL IT A WIN-WIN SITUATION.

What started as a desire for larger closets became a much-needed style and storage overhaul of Molly and John Downs' Atlanta master bath.

"The existing shower made both of our closets extremely small for a master," Molly says. "But for bigger closets, we needed to bump out the room a few feet to the outside and reconfigure the bathroom." On top of those architectural issues, the design of the bath was stuck in the 1990s. So the Downs opted to tackle all the problems at once.

Bath designer Matthew Quinn and interior designer Denise Gratigny addressed the layout first. Out went the poorly placed shower, a move that almost doubled the couple's closet space, while a bump-out made room for other elements. "We were only allowed to enlarge the bathroom by 4 feet because of the property line, but the new layout solved every issue and added an incredible amount of classicism to the space," Quinn says.

The bump-out accommodates a water closet, a spacious walk-in shower, and the room's centerpiece, a sculptural tub that sits alone under a new barrel-vault ceiling. Two stately,

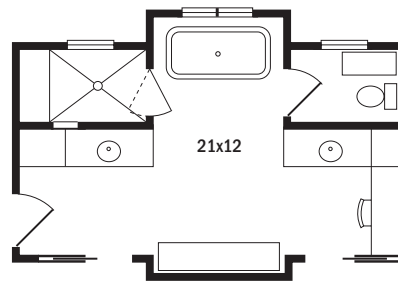

BELOW LEFT: Vintage-inspired shower fixtures in polished nickel pair perfectly with classic subway tile in a pale blue hue. **BELOW MIDDLE:** A separate water closet maintains privacy in the shared space. Inspired by nature, a hand-painted mural adds an unexpected twist to the room's classic design. **BELOW RIGHT:** Hammered-metal pulls give the shower door a distinctive look. **OPPOSITE:** The elegant shower area includes honed marble floors and a herringbone tile inset for interest. A floor that slopes to the drain allows for a curbless entry.



Takeaways

- 1** Separate vanities accommodate a couple's individual routines.
- 2** Placing a sculptural soaking tub in a windowed bay, complete with a chandelier overhead, distinguishes it as a focal point.
- 3** A tall linen cabinet boosts storage without taking up much floor space.
- 4** A toilet compartment provides privacy in a shared space.

furniturelike vanities, packed with storage, feel at home on opposite ends of the existing space.

Aesthetically, everyone welcomed a clean slate. "The old bathroom had been somewhat more feminine," Molly says. "I've always loved a blue-and-chocolate combo, so we decided to go with light blue tile and darker cabinets to bring in a more masculine look."

Honed marble floors and glossy marble countertops in light tones add contrast to the rich vanities. "All of the details came from Molly wanting a classic look—things that would be timeless, like polished-nickel fixtures and sconces," Gratigny says. For a special touch, Gratigny hired a decorative painter to create a bird-theme mural in the water closet. "Like a powder room, a water closet is a stand-alone space that can be different, so we thought the paint treatment adds more interest than just wallpaper," she says.

Having separate areas for each of them is the couple's favorite thing about their updated retreat. "We each have our own side of the bathroom with everything we need—our own vanities and closets," Molly says. "It's so nice to each have our own space." **KBI**

RESOURCES BEGIN ON PAGE 138.

